

...CONTINUED FROM THE MARCH, 1996 BULLETIN.....

MARY LEE BARNES
917 LANE #3
ATHENS, TEXAS 75751

In the book, The Mackeys and Allied Families by Beatrice Mackey Doughtie, 1957(p. 735) is proof that Alexander Douglas had another land grant. "John Makky(sic): Pursuant to a Wt by John Winn, Esq. Commsr. of Locations in Camden Dist. dated 15 Mch 1785, I have admeasured and laid out to Alex Douglass a plantation of 640 a. situate lying and being on both sides of Camp Crk. on N.E. side of Catawba River bounded on NW by Mary Douglass and John Makky's land and vacant land; NE by Robt. Carnahan's and James Adams land & vacant land and SE by vacant land. Certified Mch 1785 (S.C Archv: Land Plats) This land was bought by Thomas Mackey, Sr. 29 June 1807." But Thos. Mackey did not buy but 100 acres at this time. (See Deed, p. 107)

Also quoting from same source, p. 782-83: The will of John T. Mackey (son of Thomas) is recorded in Lancaster Co(A-308) and was sg. 18 Sept 1882 pr. 2 Dec 1882, naming following heirs:

w: Mary, "100 a. wheron I now reside known as a part of the Alex Douglass lds & a prt of the Twitty lads commencing at a line between my ld. & lds. of Col. T. F. Clyburn on a branch called Kater br. running in NE direction & in Sw direction dividing the Twitty lds. from the Douglass lds. following the Twitty line in a S. Easterly direction to the road leading from my home to Camden Road; running a straight line from thence to the ford of Camp Crk. near my house thence down the sd Crk to the beginning corner where my ld. and T.F. Clyburns joins."

This gives then a description of the land and can be more definitely pinpointed. Mrs Doughtie further states that the plantation that John T. Mackey inherited was between White Oak Branch and Camp Creek. When that homestead burned, he built another about one-third mile from the old home site which is standing today. (1957) and that John T. and his w. are buried in Mt Carmel Methodist Church Cemetery on the Mackey plantation in Lancaster Co., S.C.

"Alexander Douglas vs. Geo Curry et al. Roll 10 Court Common Pleas : George Curry, William Curry and William Carnahan were attached to answer to Alexander Douglas in a plea wherefore with force and arms and so forth, the said George Curry William Curry and William Carnahan did break and enter the close or plantation of him the said Alexander Douglas Situate on the waters of Camp Creek on the East side of the Catawba River in the District aforesaid and him the said Alexander from the same did eject and hold out and other wrongs and enormities to him did whereupon the said Alexander by Samuel Mathis, his attorney complains and says that the said " This was filed 1 January 1788 and the suit was countered by the defendants that they were not guilty. Daniel Brown... attorney. Alexander asked for Twenty pounds Sterling for damage done against the peace of the said state and five hundreds pounds Sterling for

his damage. It seems that George Curry was claiming some of Douglas' land, and a resurvey was ordered in 1793. This went on until 1794 when the three named by Douglas were judged guilty by the jury and were to pay Alexander Douglas all the cost and charges aforesaid.

A plat is shown as resurveyed by Wm. Gaston Dept Surveyor.

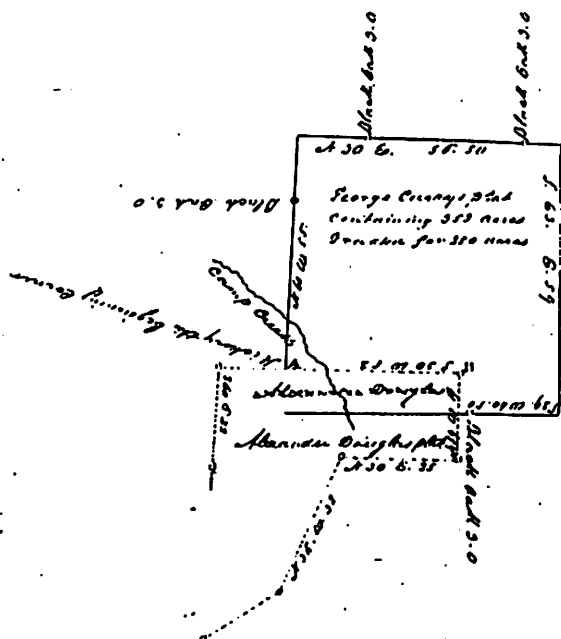

State of South Carolina. Pursuant to an order from the Court of Commons Pleas I have resurveyed the Lands in dispute between Alexander Douglas and George Curry, William Curry and William Barnahan Defendant the Black lines represent the lands claimed by Messrs Curry the dotted lines represents the Lands claimed by Mr. Douglas.
Certify'd 18th Novr 1793 *Wm. Gaston Dept Surveyor*

Chester and Lancaster County, South Carolina
 Douglass Families

From Lancaster County Deeds Bk f.p. p. 71. John McMaster deeded land to sons Thomas and William McMaster 10 Jan 1801. William Mounce and William Mounce, Jr. were Wit. and it was proven 30 May 1791 before Jas Douglas, J. P.

Lancaster County Deeds bk. b. p. 201 Aug. 1788 Thomas Creighton of Lancaster, planter deeded to John Creighton of same planter 100 acres adj James Miller and James Douglas. Thomas Creighton (LS) wit. John McClure, Jenny Creighton (X) pro. 23 Oct 1788 by John McClure, before John Lowry, J. P.

Chester and Lancaster County, South Carolina
Douglass Families

JAMES DOUGLASS OF CRAVEN COUNTY, SC.

JAMES DOUGLASS ARRIVED ABOARD THE SNOW, JAMES & MARY, 12 JAN 1768 FROM U, NORTH IRELAND. His age is listed as 40 years, and he was accompanied by his wife Agnes age 50? and children: Mary age 14, Alex age 14 and Isabell age 12. On the same vessel was also a James Douglass age 34, wife Rose age 32, and their children: Mary 8, Robert 11, , James 4, By 1775 James and Rose Douglas and family were located in what is now Chester County, SC near Fishing Creek. It is likely the two James are related to each other as well as to the James who arrived 1773. Cemetery Records of this family appeared in Chester County Genealogical Society Bulletin in December 1991.

James and Agnes Douglass appear to have settled in Craven County in that part which was later Lancaster Co. and Kershaw Co. On 12 Sept 1768 James received a grant of 300 acres in Craven Co., SC, East of the Catawba on both sides of Beaver Creek. James wrote his will in 1790 naming his children: Martha, (born after 1768?) Mary and Alexander. Isabell was not named nor Agnes, indicating their death prior to 1790. (this researcher has doubts that Agnes was 50 years old or if she was, was not the wife of James, but a sister). The will was probated in Kershaw County; the husband of Martha was William Mounce who was named Administrator because Martha who was named executor refused? But Probate Records have not been found. He left Alexander only his wearing apparel.

End Notes and References

1. Much of this last material was sent me by Alton Douglas 3902 Woodbridge , Virginia who is researching the Douglas/s Families in North and South Carolina. Material from Mrs. Shirley Allen 2344 Northumberland, Orange, Ca. 92665..
2. Transcript of the Will of James Douglas of Lancaster County, Beaver Creek. SC Archives. Rec. Will book C pg. 126; rec. Mar 1 1794 apt 21 pkg 722.
3. Brent Holcomb, Kershaw County, South Carolina Court Records, pp. 50-51. .

Chester and Lancaster County, South Carolina
Douglass Families

Will of James Douglas 1790

In the Names of God Amen I James Douglass of South Carolina Lancaster County Beaver Creek, Being through the abundant mercy & goodness of god, the weak in body yet of a sound mind and perfect understanding and memory, doth constitute this my last Last and devise it may be received by all as such I will first a that all Lands whereon I now Live and all the lands join them altho., of different tracts Excepting fifty acres with all my goods and Chattels & Stock Except Cloathing or Cloaths unto my loving daughter Martha. Next I will unto my loving daughter Marey the above Excepted fifty acres of land on that side Next John Creightn Lands during her life or while she is pleast to live thereon. Likewise i will unto sd Daughter Marey one Hundred Acres of Land Lying on a branch of Hanging rock joying hangind rock plantation having no power to dispose or Morgage said Lands without the consent of her sister Martha, next I will unto my loving son Alexander all my clothing this is my wearing apperral i doth live (sc) my Daughter Martha Exectrix. of this my last will and testament in witness whereof I have hereunto set my hand and seal this fourtheenth Day of October one thousand seven hundred and Ninty-----

James Douglas SEAL

Witness Present

Thomas Creeghton
James Trantham
his?
Agexness-x- Creeghton
mark

Rec Will book C pg 126
Recorded Mar 1 1794
Francis Beykin C.C.
Apt 21 pkg 722

From Kershaw County Records 1 Mar. 1794
p.136

Ordered that William Mounce Do Receive letters of Administration with the will annexed on the estate of James Douglas the Securities are

p.138

Ordered that William Mounce do Receive letters Testamentary in behalf of his Wife who was Executrix of James douglas deceased.

Chester and Lancaster County, South Carolina
Douglass Families

This family is almost certain to be related to the Alexander Douglass Family of Lancaster Co., SC. In 1819 Alexander wrote to his son, Ebenezer, in Butler Co., Oh and indicated that Ebenezer was visiting his cousin, James, and James' father. It is likely that John Douglass is the father of cousin James Douglass. Ebenezer was married in Preble Co., Oh and several of his children were born there. Some of the children of this James Douglass also relocated to Preble Co., Oh. and were members of the Hopewell ARP Church.

James Douglass b. ca. 1734 County Antrim, Ireland d 11 May 1808 Chester Co., SC bu Hopewell Cm. 4/32? Chester Co., SC 3 Jun 1808 Chester Co., S.C. Immigrated after 2 Aug 1773 from Ahoghil, Ireland to SC m. Mary ? Douglass Ireland before 1770. , b. ca. 1736 County Antrim, Ireland d. 28 August 1798 Chester CO.,S.C. p. Immigrated after 2 Aug 1773 from Ahogill, Ire. to SC.

- i. Elizabeth Douglass b. 1770 Ireland; d. 24 Dec 1831 Chester Co.SC; bur. Hopewell Cm. Chester Co., SC; never m. ; 4th daughter.
- ii. Mary Douglass, b. 1771 Ireland ; d. 14 Apr 1845 Preble co., Oh br Hopewell Cemetery, Preble Co. Oh. m. William McCreary b. 1775; d. 1822 Preble co., Oh.
- iii. Robert Douglass b. 1774 SC d. 15 Aug 1842 Preble Co., Oh. bu. Hopewell Cem. Preble Co., Oh. ; m. Jane Douglass b. 1777; d. 10 Feb. 1853; 1 son, 5 dau. Relocated to Ohio ca. 1808-1810.
- iv. Jean Douglass b. ? 2nd daughter m. Robert Galloway;
- v. Margaret Douglas b.: 3rd daughter m. George McDill bf. 1807; s. after 1861 ILL. George & Margaret relocataed to Newton Co., Ga.(Now Henry) in 1823 along with many other Chester co., families asociated with Hopewell Churches of Chester and Newton Counties. They were members of the Hopewell ARP Church in Newton Co. Two acres of the 6 acres owned by the Hopewell Church was secured from George McDill. Sometime after 1831 George removed to Illinois and was there in 1861.
- vi. John Douglass b. 1776 Chester Dist., SC; d. 28 June 1840 Preble Co., Oh; bu Hopewell Cem Preble co., Oh (R4) m. Martha Chestnut Douglas 1783; d. 21 Sep 1851 Oxford, Butler Co., Oh; bu. Hopewell Cem. Preble Co., Oh (R4); Relocated to Oxford, Ohio in the 1820' (By 1819)
 - a. James Douglass b. Chester Dist, SC d. Oh This is probably the cousin James who was being visited by Ebenezer Douglass in Butler Co., Oh in 1819.

Chester and Lancaster County, South Carolina
Douglass Families

- b. Jane Douglass , b. Chester Dist, SC m. Calvin Herron , 5 children.
- c. Martha Douglas b. 1895 Chester Dist, SC d. 6 May 1890 ; m. Sam McQuiston; no children.
- d. Mary Douglass b. 1805 Chester Dist., SC; d. 18 Oct 185: Preble Co., Oh; bu Hopewell Cem. Preble Co. Oh.; never m .
- e. Elizabeth Douglass b. 1812 Chester Dist., SC; d. 7 Feb. 1863 Preble Co. Oh. bu Hopewell Cem Preble co., Oh.
- f. Margaret Douglass b. Chester Dist, SC d. Preble Co., Oh. bu Hopewell Cem Preble Co. Oh ; never m.
- g. Samuel Douglas b. 15 June 1816 Chester Dist, SC; d. 26 June 18?? Butler co., Oh bur . Oxford , Butler co., Oh. m. Jane Isabel Coulter
- h. Robert Douglass b. 2 Oct 1819 Chester Dist. SC; d. 12 Apr 18?? (OH); m. E.J.. Israel Township Butler Co., Oh 1 son 5 dau.
- i. William Douglass b. 2 Oct 1819 : Chester Dist, SC: d. 11 Jan 189? Butler Co., Oh.; bu Oxford Cem (Sec 50)
- j. John Douglass, Jr. b. 15 Aug 1822 Chester Dist SC? d. 25 July 188? Butler co., Oh ; bu Oxford Cem (Sec 50) m. (1) ? Marshall m. (2) Elizabeth Barid b. 1829;d . 8 Oct 1859.
- i. Isaiah Douglas b. Aug Chester Dist SC? d. 2 Dec. 1906 Butler Co., Oh bu. Oxford Cem, Butler Co., Oh. Farmer, Morning sun road, Oxford, Butler co., Oh m. Ann Patterson b. Oct. 1841 IRe. d. May 1901 Butler co., Oh bu Oxford Cem. Butler Co., Oh.
 - 1. Albert John Douglass b. 21 Mar 1864 Butler Co., Oh.; d. 20 Mar. 1937 Butler Co., Oh; m. Anna Sthyr 3 Nov. 1885. .
 - 1a. Leonore Douglass
 - 1b. Frieda Douglass
 - 1c. Dwight Douglass
 - 1d. Mary Douglass
 - 2. Martha E. Douglass b. 21 Sept 1868 Butler Co., Oh; m. George Roll 27 Dec. 1894; d. 2 Sept 1895.

Chester and Lancaster County, South Carolina
Douglass Families

3. William C. Douglass b. 20 Apr. 1871
Butler Co., Oh; d. 18 Feb 1953; Norwalk,
Ca.; m. Lillian Applegate.

- 3a. Arthur Douglass
- 3b. Paul Douglass
- 3c. Roy Douglass
- 3d. Floyd Douglass

4. Samuel Lyle Douglass b. 2 June 1878
Butler co., Oh d. 16 Jan 1926 Butler co.,
Oh m. Lessie Shultz 26 Nov 1902.

4a. George Douglass

5. Zadie Maggie Douglass b. 24 apr 1876
Butler co., Oh; m. Clifford Shultz.

- 5a. Frances Shultz
- 5b. Lucille Shultz

vii. Agnes Douglas b. (SC?)

.....TO BE CONTINUED IN THE SEPTEMBER, 1996 BULLETIN.....

* * * * *

AUGUSTA GENEALOGICAL SOCIETY, INC. presents its 17th Annual
HOME COMING - AUGUST 23-25, 1996. For registration Form and
Further Information: Augusta Genealogical Society, Inc., P. O.
Box 3743, Augusta, GA 30914-3743. Phone # 706-738-2241.

**UNDER THE LEAVES OF THE PALMETTO, Vol. 1 and HISTORIC PROPERTIES
OF YORK COUNTY, SOUTH CAROLINA.** The Historic Properties Book is
\$20.00. and Under the Leaves is \$10.50; shipping and handling is
\$5.00--Total \$35.50. Make check: Historical Center of York
County, 212 East Jefferson Street, York, SC 29745.

NORTH CAROLINA ARCHIVES- The 1995 Catalog of the NC Archives is
available **FREE** upon request. New titles and those of
genealogical interest are noted. Write: Historical Publications
Section, Division of Archives and History, 109 E. Jones Street,
Raleigh, NC 27601-2807. Or call 919-733-7442.

VIRGINIA REVOLUTIONARIES --Looking for Virginia ancestor in
Revolutionary War? Try the Virginia State Pension Records. The
Virginia pension was more than the Federal pension, so 465 former
soldiers and/or their widows chose their Virginia benefit. Thus
their names may be on the Virginia pension list, but not on the
U. S. Pension list.

* * * * *